

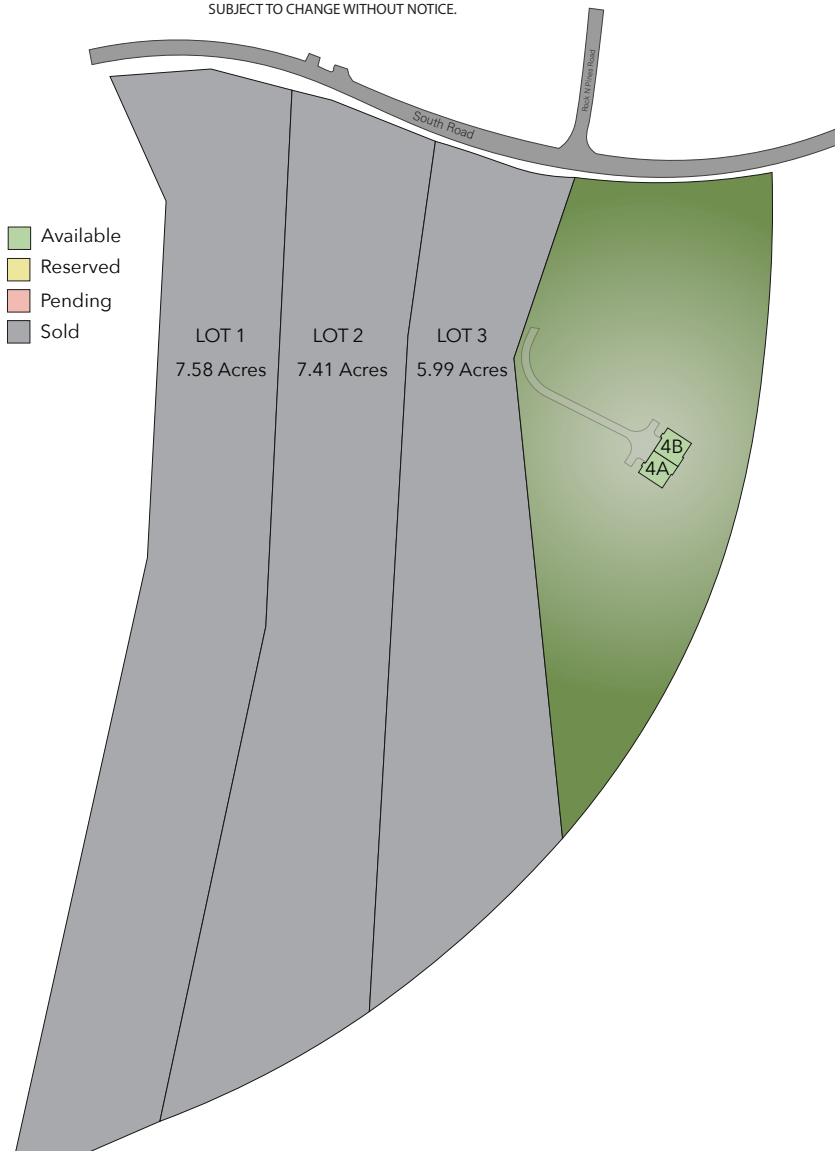

TRAILSIDE CROSSING

Welcome to Trailside Crossing, **5 homesites** abutting the **Rockingham Recreational Rail Trail** and **conservation area** in **serene Fremont, New Hampshire**. This quaint community will feature **one duplex and three single-family homes** built by Wright Builders on **lots ranging from 5.99 to 7.58 +/- acres**. Walk out your back door to the abundance of **nature, trails, and conservation area**.

FOR MARKETING PURPOSES ONLY. NOT TO SCALE.
SUBJECT TO CHANGE WITHOUT NOTICE.



**For more information and
to view available lots**

Visit us online at:
**TheGoveGroup.com/
Trailside-Crossing**

or

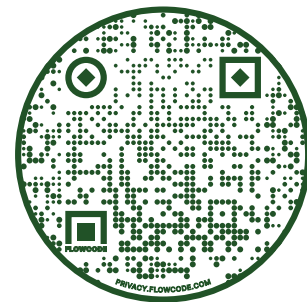

or

Text
TRAILSIDE
to 603.686.8272



FREMONT, NH



Drive to: **Brickyard Square Epping** 12 min



Drive to: **Boston, MA** 1 hr 14 min



Drive to: **Downtown Manchester** 33 min



Drive to: **Portsmouth** 36 min

BUILDER



For more information about Wright Builders and our other current projects please visit us online!

SALES AGENT



CRAIG FORMALARIE, REALTOR®

603.490.4281 | direct
cformalarie@thegovegroup.com



The Gove Group Real Estate, LLC.

70 Portsmouth Ave | Stratham, NH 03885 :: 603.778.6400
952 Post Road, Suite 9 | Wells, ME 04090 :: 207.618.5000
TheGoveGroup.com